

Typ BS und BST

Standard Dreh-Kipp-
Fenster und Tür

Holz-Alu-
Fenster

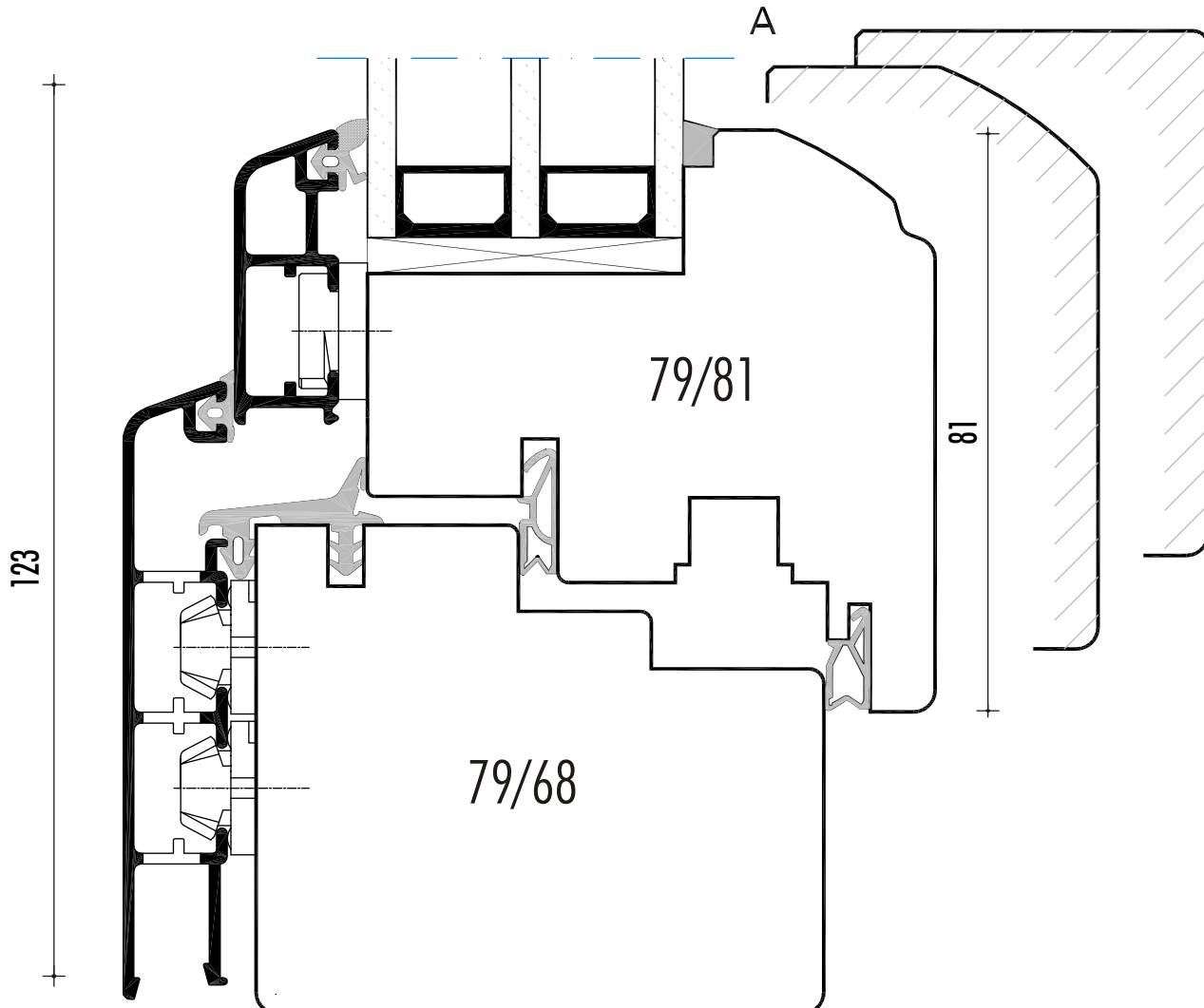

Typ BS und BST

Standard Dreh-Kipp-
Fenster und Tür

Holz-Alu-
Fenster

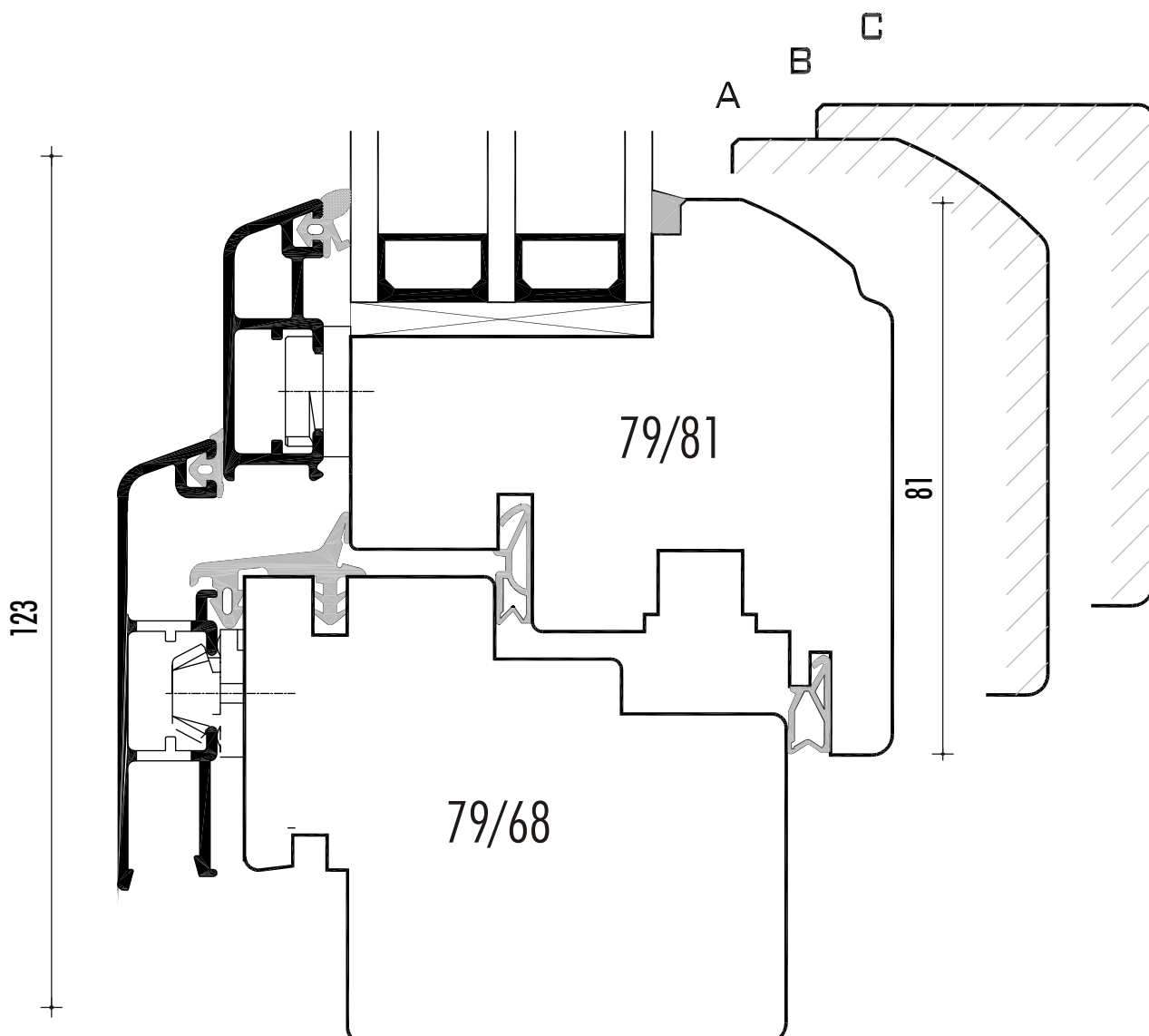

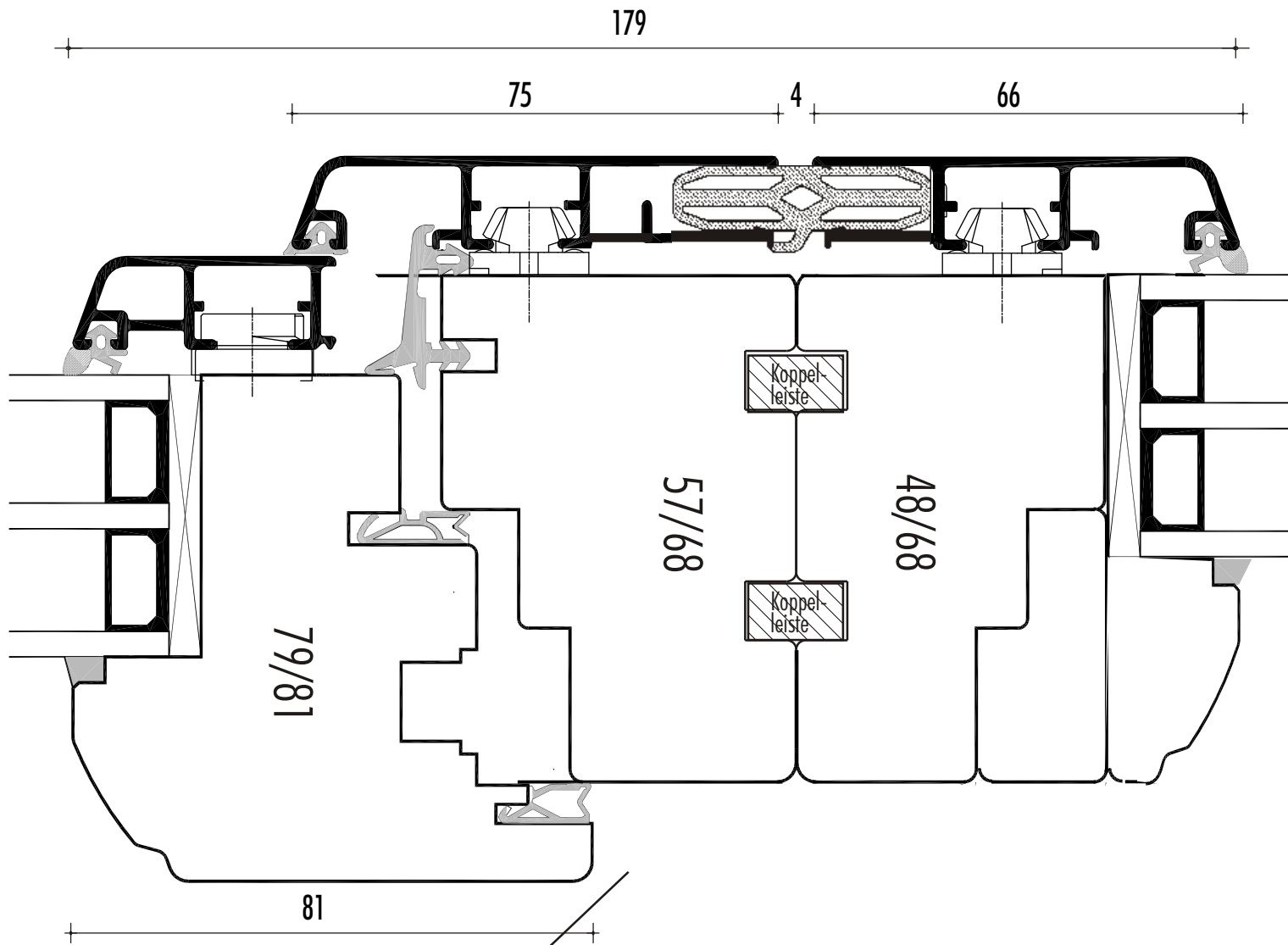

Roto Designo erforderlich

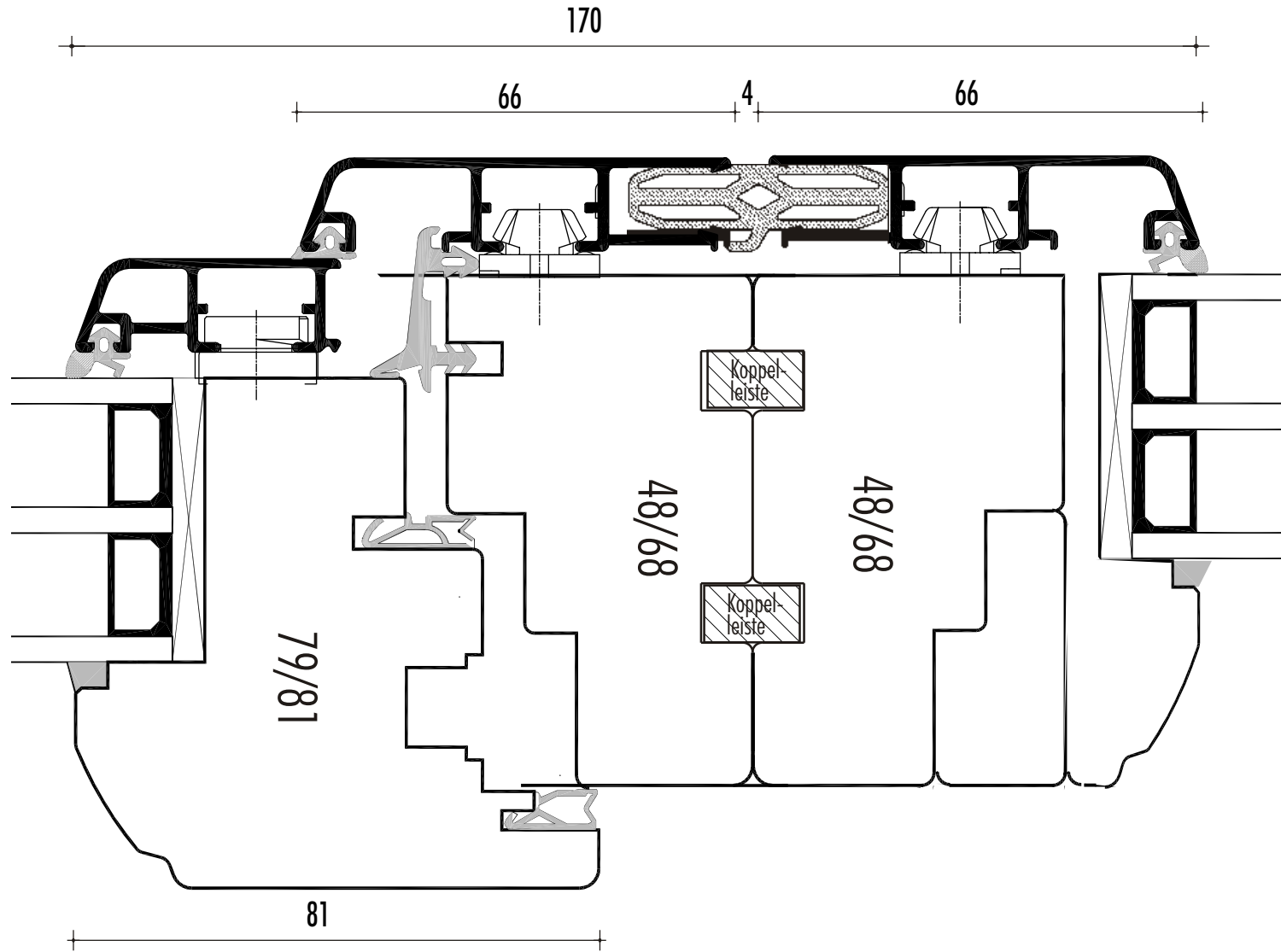

Kopplung
DK - fest

M 1:1

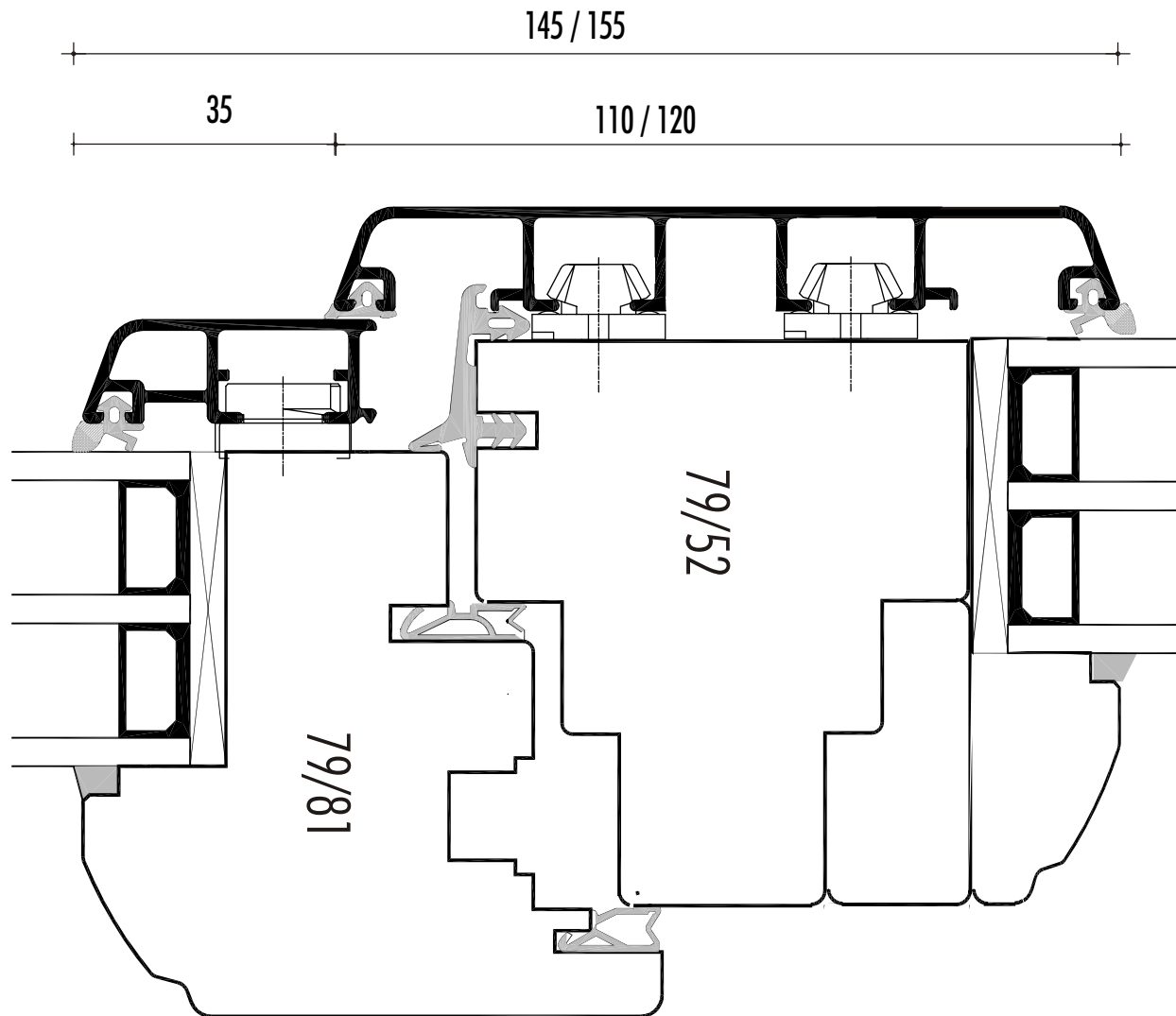

DK - fest

M 1:1

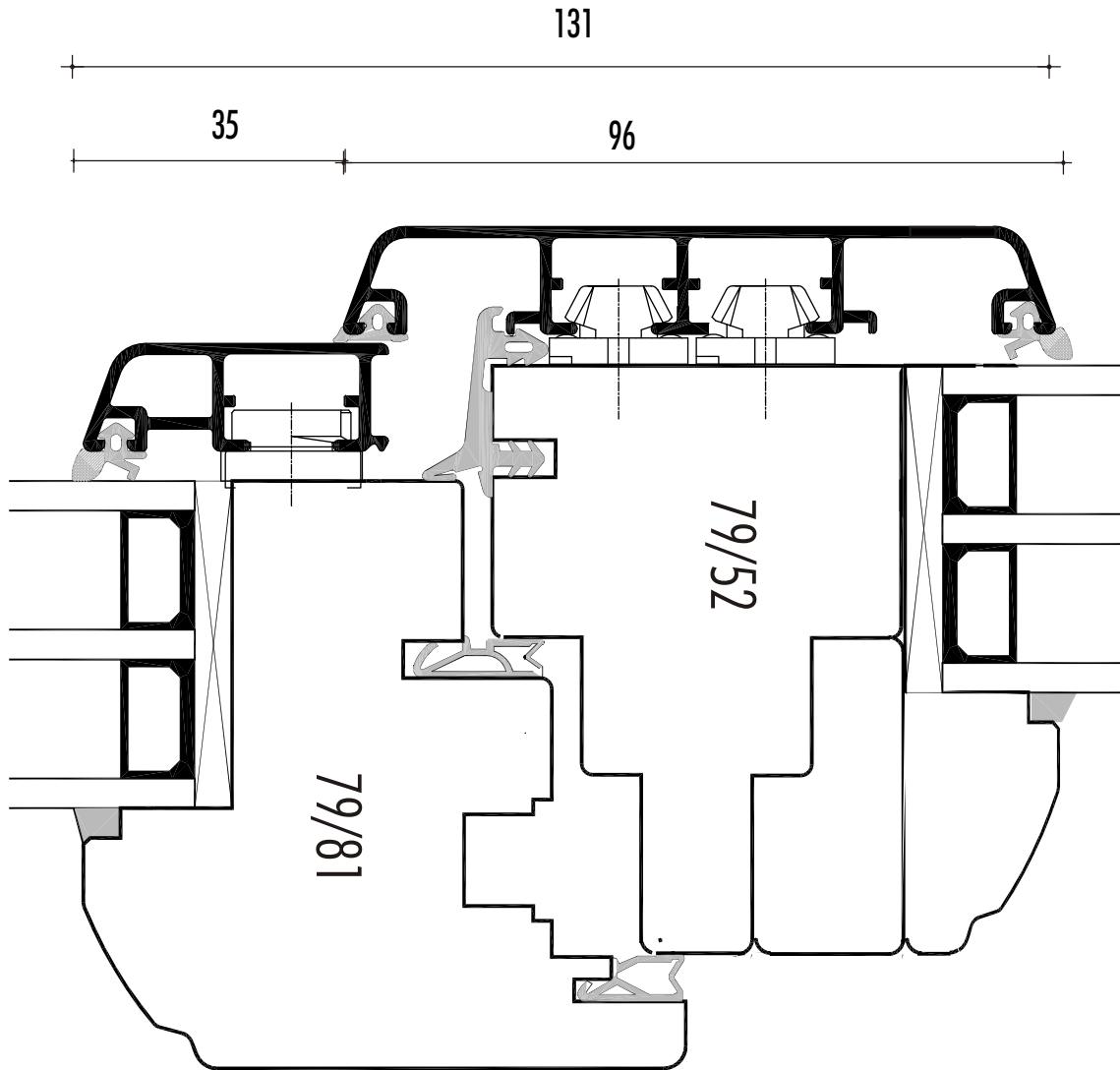

DK - fest

M 1:1

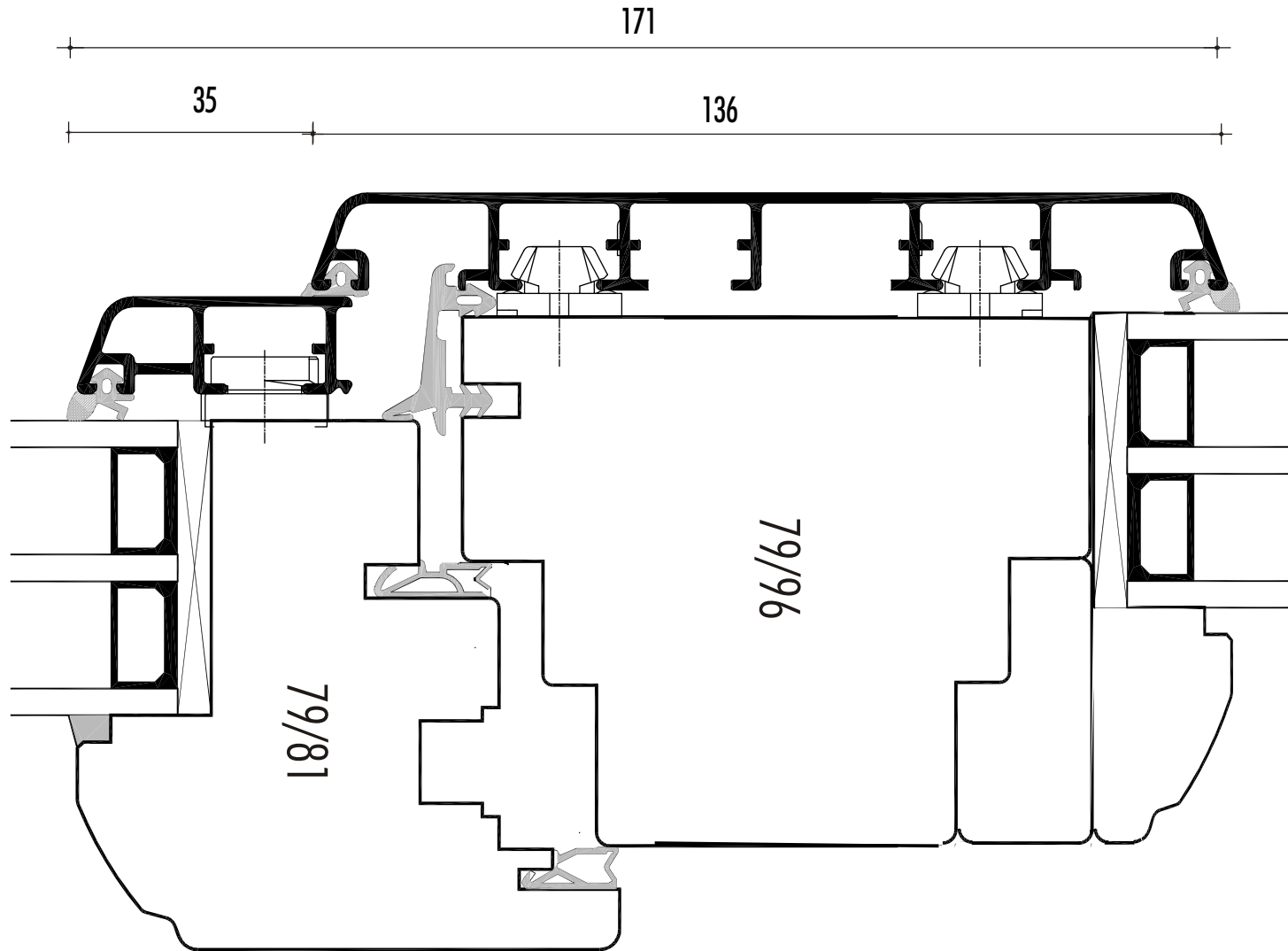

DK - fest
Pfofen
136mm

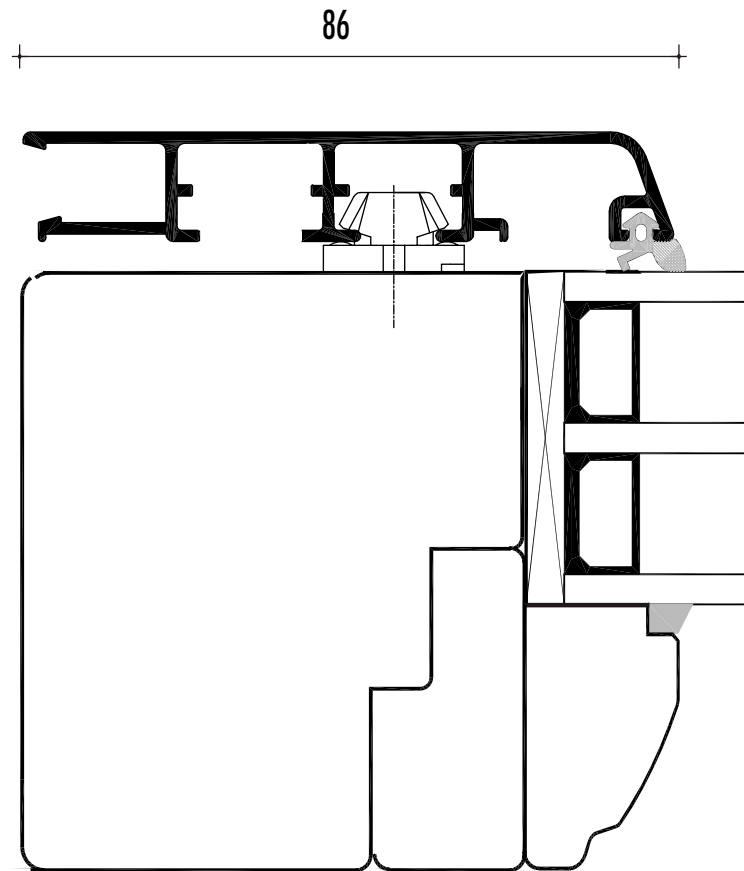

fest im
Blendrahmen

M 1:1

gruppierte
Linien

Blendrahmen

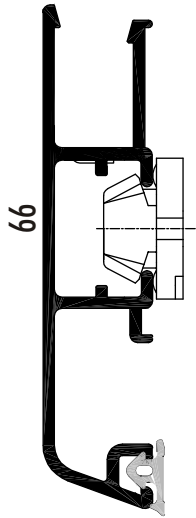

66

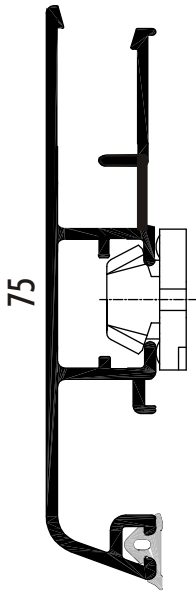

75

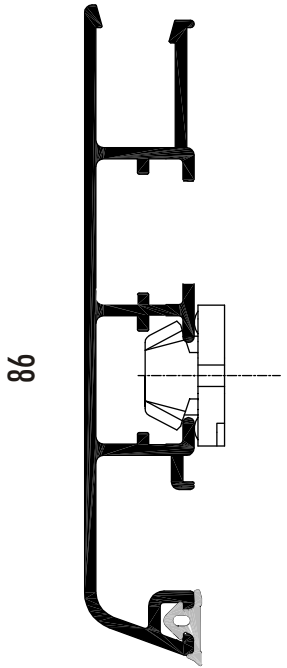

86



Pfosten

96 / 110 / 120

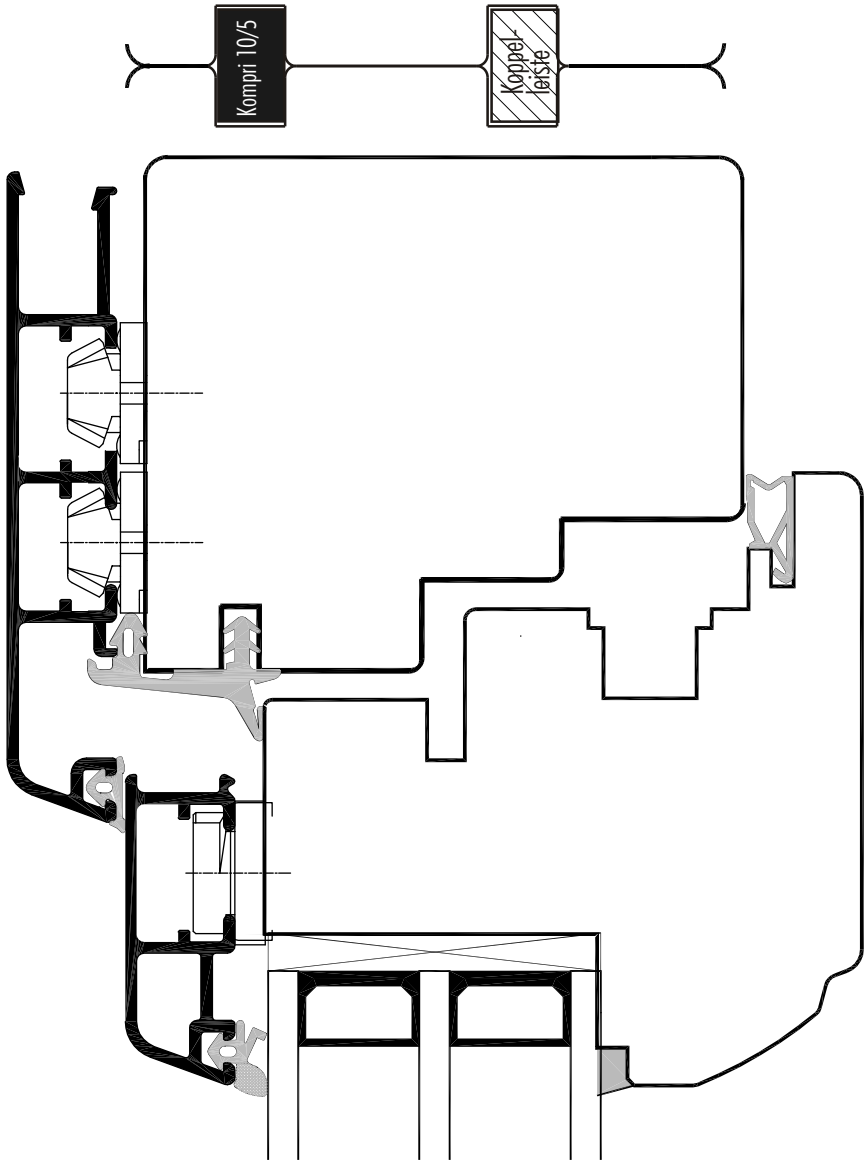
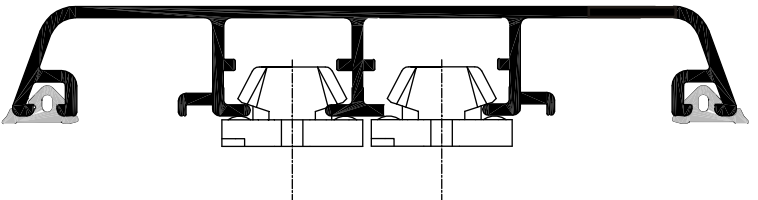

Kompri 10/5

Koppel-laste

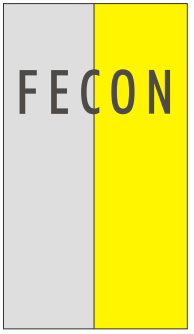
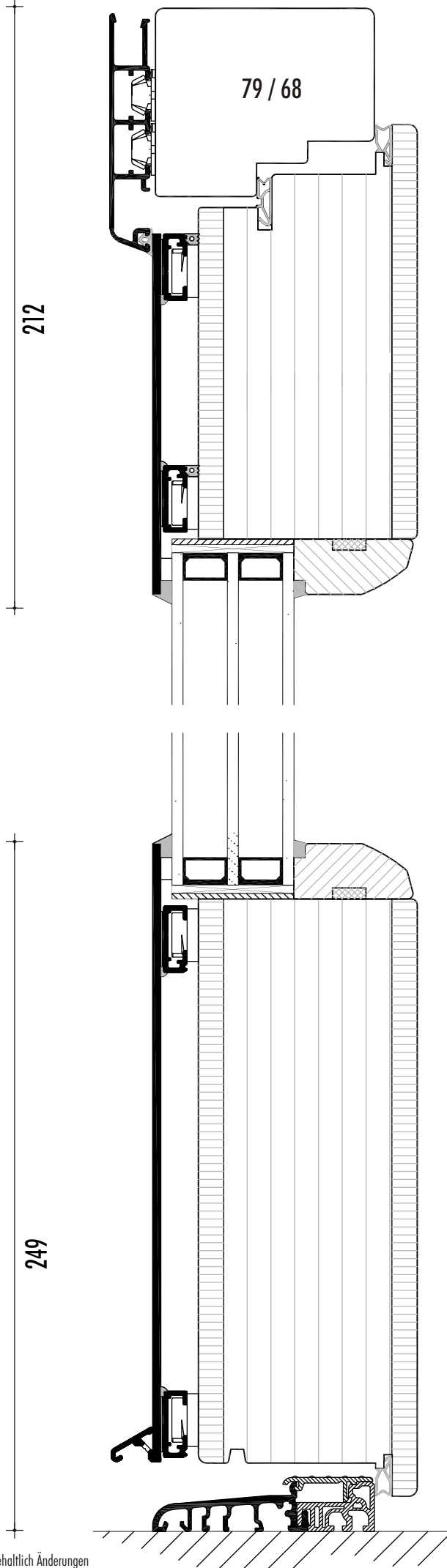

Holz-Alu- Haustür

Dämmwert nach DIN
EN ISO 10077-3
bis 0,7 möglich

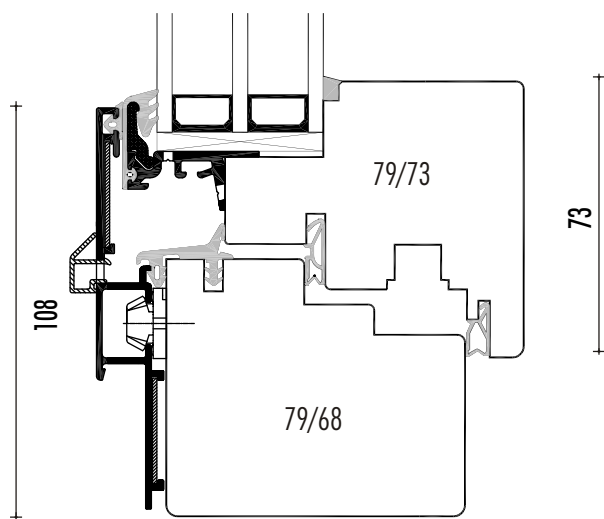
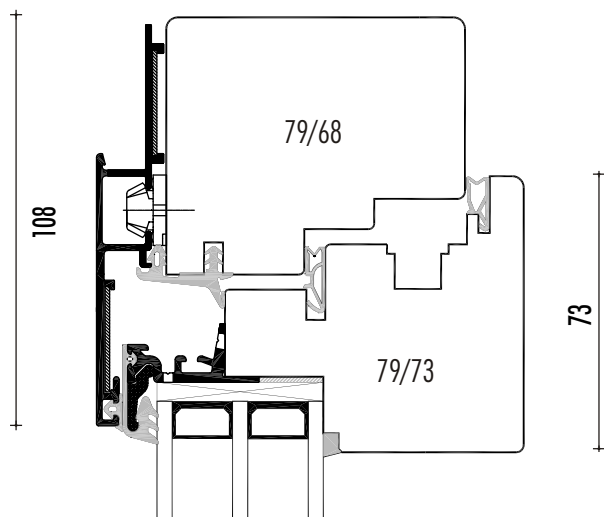
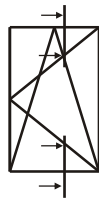

Holz-Alu- Flügel verdeckt Fenster und Tür

Dämmwert nach DIN
EN ISO 10077-3:
1-flg. 1230 x 1480
Verglasung Ug 0,6

Uw 1,02



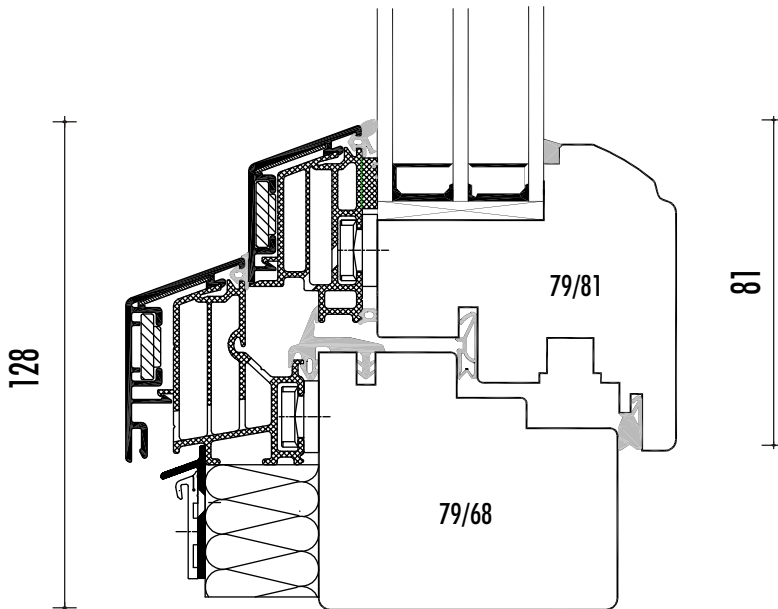
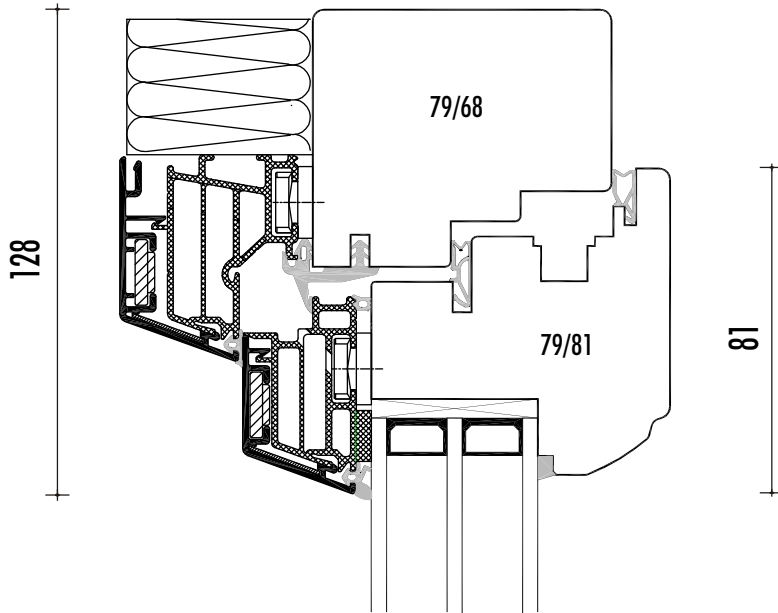
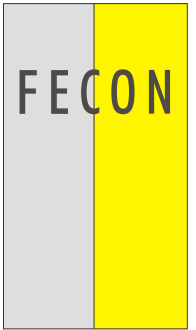
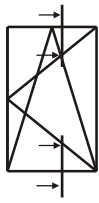

Holz-Alu- Warmfenster u. Tür

Dämmwert nach DIN
EN ISO 10077-3:
1-flg. 1230 x 1480
aus Kiefer o. Lärche
Verglasung Ug 0,5
Uf 0,84 / Psi- 0,037

Uw 0,709

